

PVC

A 70 Hinged System

A hinged system with a 70 mm frame depth and a maximum glazing capacity of 40 mm.

Its 5 chamber profiles both in frame and sash affords it great energy efficiency with transmission values from 1,0 W/m²K, converting it into an ideal large window to guarantee compliance of the most demanding norms that are applied to whatever climatic zone.

It has two sash design shapes, bevelled and straight.



A 70 Hinged System - PVC

Transmittance

Uw from 1,0 (W/m²K)

Please consult typology, dimensions and glass

Acoustic insulation

Maximum glazing: 40 mm.

An example of the acoustic insulation depending on the glass:

Glass	Reduction in sound level
8/10/4	Rw(C,ctr)=34(-1;-4)dBA
10/12/6	Rw(C,ctr)=35(-1;-3)dBA
6/14/5+5	Rw(C,ctr)=36(-1;-4)dBA

Calculations according to EN 14351-1:2006

Categories achieved at test centre

Air permeability
(EN 12207:2000): Class 4

Water tightness
(EN 12208:2000): Class E1800

Wind resistance
(EN 12210:2000): Class C5
Reference test 1,30 x 1,30 m. 2 sashes

Finishes

Dual colour possibility
White
Smooth colours
Imitation Wood effect



Sections

Frame 70 mm.

Sash 80 mm.

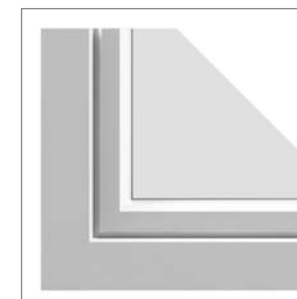
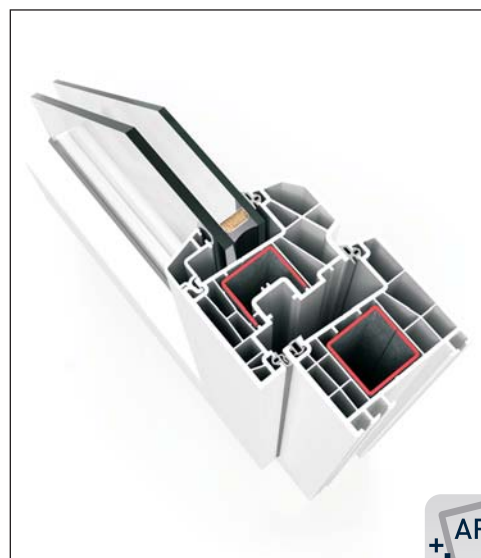
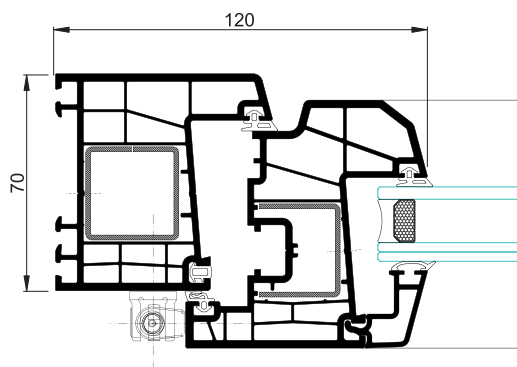

Opening possibilities

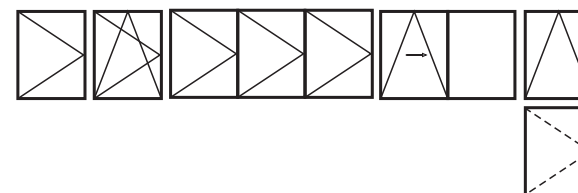

Open in: practicable, turn-tilt, folding, parallel tilt, hinged.

Open out: practicable.

Maximum dimensions

Width (L) = 1.000 mm.

Height (H) = 2.150 mm.

1 sash door turn-tilt

Please consult regarding maximum weight and dimensions for other opening types

Maximum weight/sash

100 Kg.